

**HIP & VALLEY**

EP6040 - SS360 - VALLEY

---

**EP6040 - SS360 VALLEY**

Download the DWG file by clicking here.

**VALLEY CONDITION ERECTION NOTES**

- 1) INSTALL THE EAVE ANGLES AND EAVE PLATES AS SHOWN AT RIGHT. CALK THE EAVE PLATES AT THE CORNER WITH H3152 TUBE CALK.
- 2) AFTER THE INSTALLATION OF THE EAVE ANGLES AND EAVE PLATES, AND BEFORE THE ROOF PANEL INSTALLATION, START AT THE LOW EAVE AND PLACE THE INSULATION PAN IN THE VALLEY AND FASTEN WITH (1) H1020 FASTENER AT EACH PURLIN. FIELD OVER THE INSULATION PAN AT THE EAVE PLATE. LAP THE INSULATION PANS 2" AND FASTEN WITH (4) H1020 FASTENERS.
- 3) INSTALL THE INSULATION OVER THE INSULATION PAN. FASTEN WITH H1020 SCREWS AND H2000 INSULATION WASHERS AS REQUIRED.
- 4) BEFORE ROOF PANEL INSTALLATION, START AT THE LOW EAVE AND PLACE THE HAT CHANNEL SECTIONS ON BOTH SIDES OF THE VALLEY. 1" FROM THE CENTERLINE AS SHOWN. FASTEN TO EACH PURLIN WITH (2) H1020 FASTENERS.
- 5) CENTER THE VALLEY PLATE OVER THE HAT SECTIONS. AT THE EAVE & ROOGE, EXTEND THE PLATE TO THE EDGE OF THE ROOF PANEL. FIELD CUTTING AS REQUIRED. FASTEN VALLEY PLATE TO HAT CHANNELS INSIDE PANEL RIB WITH (1) H1020 FASTENER AS SHOWN BELOW. LAP THE VALLEY PLATE 2" & FASTEN WITH (2) H1020 FASTENERS.
- 6) PLACE THE DIVERTER FLASH OVER THE VALLEY PLATE AND TEMPORARILY FASTEN WITH (1) H1020 SCREW AT THE OUTSIDE CORNERS OF THE VALLEY PLATE. DO NOT USE THE VALLEY AS A WALKWAY OR A WORK PLATFORM.
- 7) INSTALL 2 1/4" TAPE MASTIC (MK. H3020) ON THE DIVERTER FLASH 1/2" FROM THE CENTER OF THE PLATE AS SHOWN. DO NOT REMOVE PAPER BACKING UNTIL READY TO SET PANEL. ALSO APPLY A BEAD OF BUTYL TUBE CALK (H3151) FOR THE FLAT OF THE PANEL ALONG THE TAPE MASTIC. PLACE ADDITION 1/2" PIECE OF MASTIC AT CLOSURE LOCATION.
- 8) INSTALL THE ROOF PANELS - CUTTING ENDS AT THE ANGLE REQUIRED. CUT PANELS 7" FROM THE CENTER OF THE VALLEY PLATE. NOTE: KEEP METAL SHAVINGS OUT OF MASTIC AND PANEL SIDELAP) REMOVE TEMPORARY DIVERTER FASTENER IF NEEDED.
- 9) INSTALL THE METAL VOID CLOSURE AS THE PANELS ARE BEING INSTALLED. REMOVE THE PAPER BACKING FROM THE 2 1/2" TAPE MASTIC AND SEAL THE VOID CLOSURE IN THE MASTIC PERPENDICULAR TO THE PANEL PANEL RIB AND FASTEN WITH TWO H1020 SCREWS. APPLY 3/4" TAPE MASTIC (MK. H3640), AND A BEAD OF TUBE CALK (MK. H3151) ON THE CLOSURE. SEE DETAIL BELOW.
- 10) BEFORE THE NEXT PANEL IS INSTALLED, APPLY A BEAD OF TUBE CALK (MK. H3151) TO THE MALE SIDE OF THE PANEL FROM THE LOW END OF THE PANEL UP 8" TO ENSURE WEATHER TIGHTNESS, AS SHOWN IN THE CALK DETAIL.
- 11) FASTEN WITH H1020 SCREWS, 2 1/2" O.C. OVER THE TAPE MASTIC (MK. H3020), 8 1/4" FROM THE CENTER OF THE DIVERTER FLASH TO THE CENTER OF THE FASTENERS; TAKE SPECIAL CARE AT THIS POINT TO MAINTAIN PANEL MODULARITY.

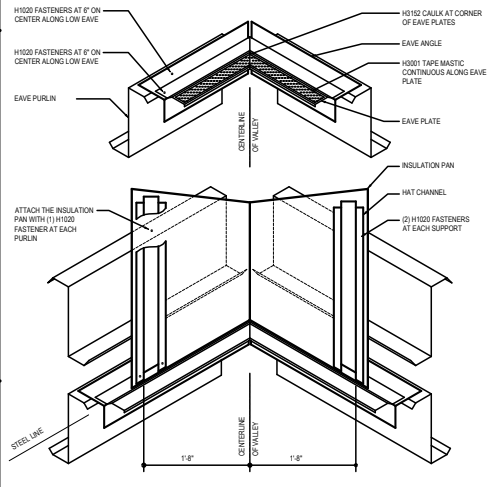

**INSULATION PAN, EAVE PLATE, AND HAT CHANNEL DETAIL AT LOW EAVE CORNER**  
SEE ERECTION NOTES 1, 2, 3 AND 4

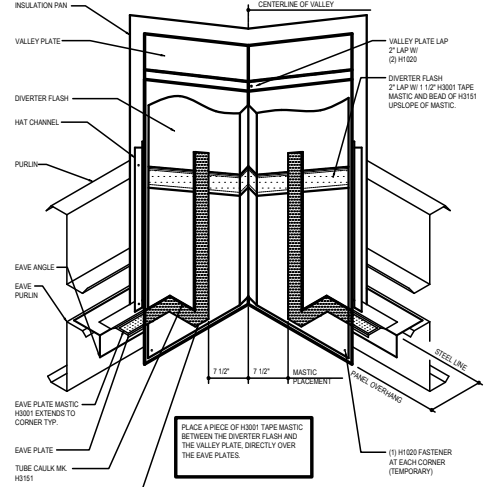

**VALLEY PLATE AND DIVERTER FLASH DETAIL AT LOW EAVE CORNER**  
SEE ERECTION NOTES 5, 6 AND 7

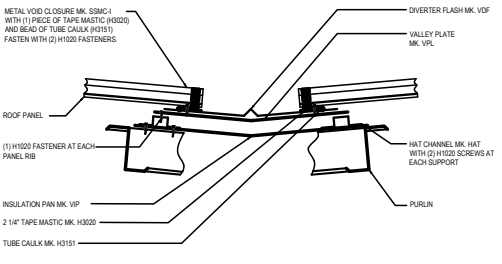

**SS360 VALLEY FINAL ASSEMBLY DETAIL**

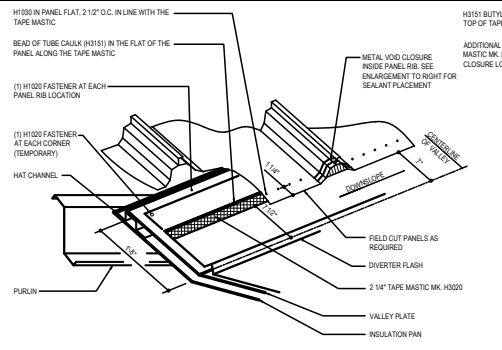

**MASTIC AND VOID CLOSURE DETAIL AT VALLEY**  
SEE ERECTION NOTES 8 AND 10

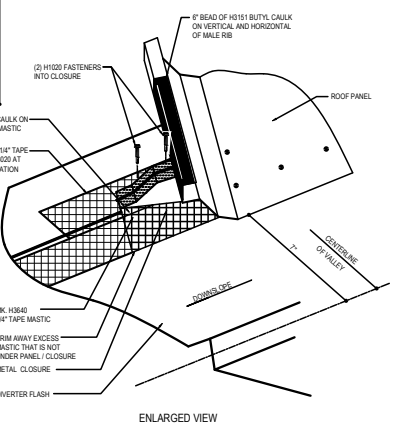

**ENLARGED VIEW**

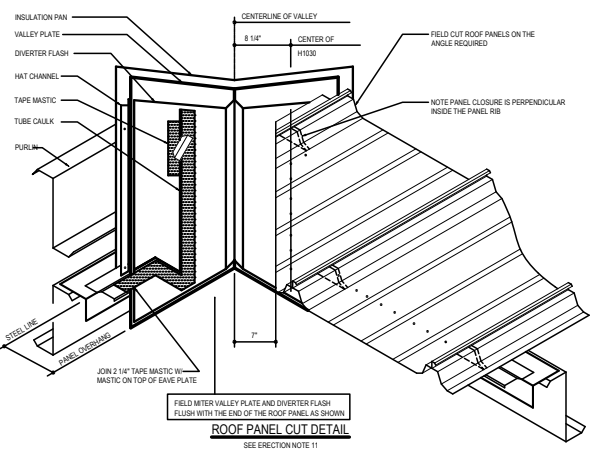

**ROOF PANEL CUT DETAIL**  
SEE ERECTION NOTE 11

**SS360 VALLEY CONDITION**  
EAVE GUTTER DETAIL w/ WALL PANELS  
SEE WALL SHEETING ERECTION NOTES FOR WALL PANEL FASTENER LOCATIONS

**Detailer Notes:**

- 1) N/A